



Dalian Zhuhong Mechanical Co.,Ltd

ООО «ТИ-СИСТЕМС» ИНЖИНИРИНГ И ПОСТАВКА ТЕХНОЛОГИЧЕСКОГО ОБОРУДОВАНИЯ
Интернет: www.tisys.ru www.tisys.kz www.tisys.by www.tesec.ru www.ти-системс.рф
Телефоны: +7 (495) 7774788, 7489626, (925) 5007155, 54, 65 Эл. почта: info@tisys.ru info@tisys.kz info@tisys.by

Catalog

- Company Profile 02
- Enterprise Honor 03/04
- Workshop Show room 05/06
- Universal Coupling 07
- Flexible Coupling 08
- Restraint Coupling-with ring 09
- Restraint Coupling-with Card block 10
- Restraint Coupling-slim type 11
- Gibault joint 12
- Universal Flange Adaptor 13
- Flexible Flange Adaptor 14
- Restraint Flange Adaptor-with ring 15
- Restraint Flange Adaptor-with Card block 16
- Restraint Flange Adaptor-slim type 17
- PE/PVC Quick Adaptor 18
- Dismantling Joint 19
- Dismantling Joint(ANSI150) 20
- Tapper Saddle 21
- Adjustable Bell Joint Repair Clamp 22



Company and Products Info >>>

Dalian Zhuhong Mechanical CO.,LTD is established in 2008 and located in Jinzhou District of Dalian City-the key transportation hub and trading port in Liaoning Province of China. With excellent production equipment, advanced manufacturing technology, perfect testing and examination facilities, strict selection for materials procurement ,thoughtful and efficient pre-sale and after-sale service, we are engaged in providing customers with first-rate customer service and lightning fast product delivery.

In the following years ,we are concentrating on developing new ideas of our products in order to meet more and more volatile applications of our customers. Our long-term business partners not only spread all over China, but also in America, United Kingdom, Spain, Australia, Russia and other Mid-East countries and South-East Asia countries.

We have long-term partners of stable raw material supplies and we keep nearly all phases of manufacturing in-house, which will make the supply chain to be simplified and extremely efficient. Parts are made to our exact specifications and design changes can be made quickly.

Our customers enjoy our ability to quickly provide top-quality products independently designed to meet their unique requirements.

Our factory is located in 30 minutes' driving to the Dalian Railway Station and 1 hour' s driving to the Dalian Airport, which make it possible for us to deliver the goods whenever they are ready immediately.

Our products categories and sales scale is growing wider. But our commitment to serving our customers and our customer' s customers is as evident today as it was we established.

We live only to achieve our manual success.



Enterprise Honor



ISO9001 Quality Management System Certificate



CE of Pipe Coupling



CE of Pipe Repair Clamp



WRAS Product Quality Certificate



WRAS Product Quality Certificate of Rubber Gasket



ACS Academia Constiintei de Sine



American IAPMO Product Quality Certificate



GOST Approval for Russia market



Brunei Official Approval Certificate



Utility Model Patent of Wide Range Flexible Pipe Coupling



Utility Model Patent of CR Lengthen Type Repair Clamp



Design Patent of Fast Install Band Repair Clamp



Utility Model Patent of Mini-Type Fast Repair Clamp



SGS Inspection Report



Membership of Chinese Belt Press Seal Engineering Association



Food Grade Inspection of EPDM Rubber Material



Food Grade Inspection of Silicone Rubber Material



Potable Water Inspection Report for Rubber Materials

Workshop



UNIVERSAL COUPLING

Code: RPA1.EME.2



Briefs

- Connection for pipes in material ductile iron, steel, PVC, AC etc;
- Working pressure PN10/16;
- Maximum temperature -10 °C to +70 °C ;
- Suitable for portable water, neutral liquids and sewage;
- WRAS approved.

Standards

- Coating: EN30677;
- Test: EN 12266-1.

Features

- Wide tolerance range;
- Corrosion resistant construction;
- Angular deflection of $\pm 4^\circ$.

Options

- GD8.8, Stainless steel, Dacromet bolt;
- Various coating;
- Seal: NBR etc;
- Ductile iron sleeve.

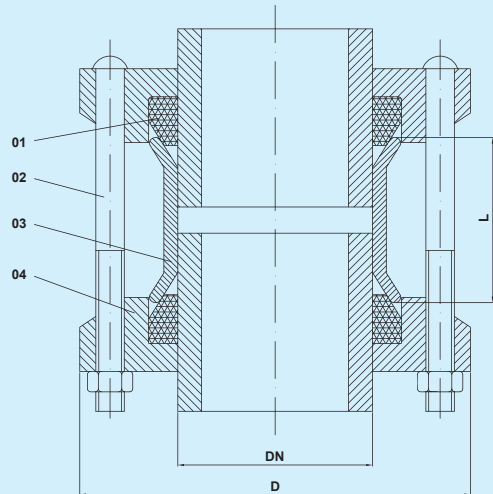

Assembly Chart

ITEM	DESCRIPTION	MATERIAL	STANDARD
1	GASKET	EPDM	EN 681-1
2	FASTNER	GD 4.8	COMMERCIAL
3	SLEEVE	STEEL	EN 10025
4	END RING	EN GJS400-15	EN 1563

DN	RANGE mm	L mm	D mm	BOLT	
				SIZE	QTY
350	340-360	150	455	M16X250	6
350	357-368	150	518	M16X250	8
350	374-391	150	568	M16X250	8
400	400-429	150	580	M16X250	8
450	418-435	150	580	M16X250	8
400	425-442	150	625	M16X260	8
450	455-472	150	665	M16X260	10
500	500-532	150	690	M16X260	10
500	527-544	150	715	M16X260	10
500	555-572	150	715	M16X260	10
600	600-630	150	790	M16X260	10

Specifications & Parameters Chart

DN	RANGE mm	L mm	D mm	BOLT	
				SIZE	QTY
50	59-72	102	165	M12X180	2
65	72-85	102	185	M12X180	2
80	88-103	102	185	M12X180	4
100	109-128	102	218	M12X180	4
125	132-146	102	250	M12X180	4
150	159-182	102	272	M12X200	4
175	192-210	130	312	M12X200	4
200	218-235	130	335	M12X220	4
250	272-289	130	405	M12X220	6
300	315-332	130	460	M12X220	6
300	322-339	130	435	M12X220	6

FLEXIBLE COUPLING

Code: RPA2.EME.2



Briefs

- Connection for pipes in material ductile iron, steel, PVC, AC etc;
- Working pressure PN10/16;
- Maximum temperature -10 °C to +70 °C ;
- Suitable for portable water, neutral liquids and sewage;
- WRAS approved.

Standards

- Coating: EN30677;
- Test: EN 12266-1.

Features

- Corrosion resistant construction;
- Angular deflection of $\pm 4^\circ$.

Options

- GD8.8, Stainless steel, Dacromet bolt;
- Various coating;
- Seal: NBR etc.

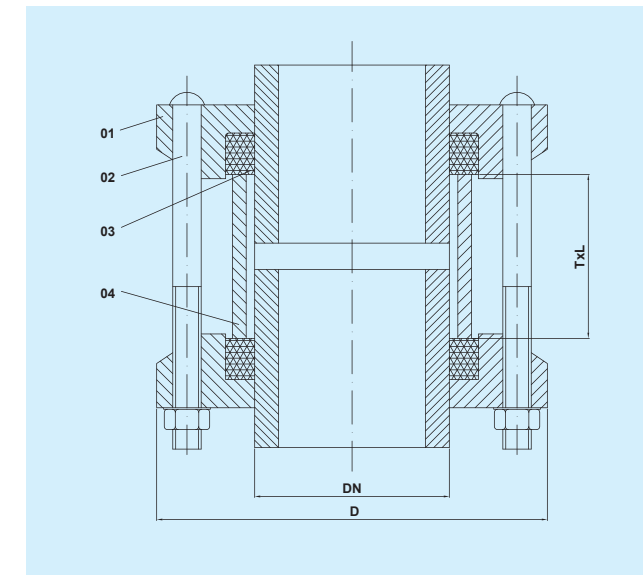

Assembly Chart

ITEM	DESCRIPTION	MATERIAL	STANDARD
1	END RING	EN GJS400-15	EN 1563
2	FASTENER	GD 4.8	COMMERCIAL
3	GASKET	EPDM	EN 681-1
4	SLEEVE	EN GJS400-15	EN 1563

Specifications & Parameters Chart

DN	NOM. O.D. mm	O.D. TOL mm	SLEEVE		D mm	BOLT	
			T(mm)	L(mm)		SIZE	QTY
80	98	+2.1 -2.6	7.1	102	178	M12x170	4
100	118	+2.1 -3	7.4	102	200	M12x170	4
125	144	+2.3 -3	7.5	102	230	M12x170	4
150	170	+2.3 -3	7.6	102	265	M12x170	4
200	222	+2.4 -3.5	7.6	102	330	M12x180	6
250	274	+2.5 -3.5	8	102	386	M12x180	6
300	326	+2.6 -3.5	8.5	102	439	M12x180	6
350	378	+2.7 -3.5	9.5	152	503	M16x240	8
400	429	+2.8 -4	9.5	152	543	M16x240	8

*Sizes 1200+ are available on application

DN	NOM. O.D. mm	O.D. TOL mm	SLEEVE		D mm	BOLT	
			T(mm)	L(mm)		SIZE	QTY
450	480	+2.9 -4	9.5	152	593	M16x240	10
500	532	+3 -4	9.5	152	638	M16x240	10
600	635	+3.2 -4	9.5	152	753	M16x250	10
700	738	+3.4 -4.5	9.5	152	853	M16x260	12
800	842	+1 -4.5	9.5	152	968	M16x260	12
900	945	+1 -5	9.5	178	1069	M16x280	14
1000	1048	+1 -5	9.5	178	1186	M16x290	14
1100	1152	+1 -6	12	178	1299	M16x300	16
1200	1255	+1 -6	12	178	1404	M16x310	16

RESTRAINT COUPLING

Code: RPA3.EME.2



Briefs

- Connection for HDPE pipe;
- Working pressure PN10/16;
- Maximum temperature -10°C to +70°C;
- Suitable for portable water, neutral liquids and sewage;
- WRAS approved.

Standards

- Coating: EN30677;
- Test: EN 12266-1.

Features

- Corrosion resistant construction;
- Angular deflection ± 3°.

Options

- A2-70, A4-80 etc;
- Various coating;
- Seal: NBR etc.

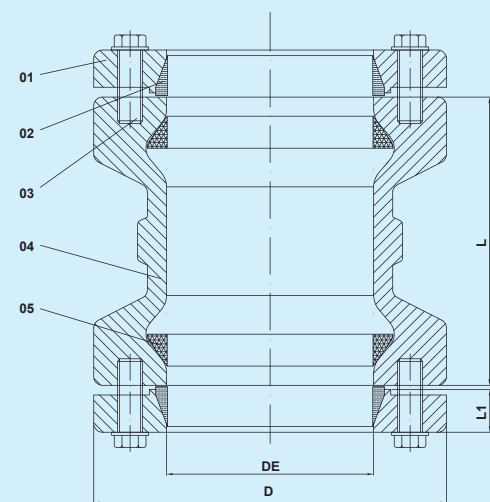

Specifications & Parameters Chart

DE	L1	L	D	BOLT
mm	mm	mm	mm	M×No.
63	20	125	130	M10×2
75	21	126	142	M10×4
90	21	128	160	M10×4
110	22	130	180	M10×4
125	22.5	134	195	M10×4
140	22.5	145	221	M10×4
160	23.5	170	235	M10×4
180	23.5	185	255	M10×4
200	25	210	274	M10×4
225	25	215	302	M10×4
250	25	240	328	M10×6
280	25	250	358	M10×6
315	25	300	392	M10×6

Assembly Chart

ITEM	DESCRIPTION	MATERIAL	STANDARD
1	END RING	EN GJS400-15	EN 1563
2	GRIP	BRASS	EN1982
3	FASTENER	STAINLESS STEEL	ASTM A276
4	SLEEVE	EN GJS400-15	EN 1563
5	GASKET	EPDM	EN 681-1

Restraint coupling

Code: RPA3.EME.2



Briefs

- Connection for HDPE pipe;
- Working pressure PN10/16;
- Maximum temperature -10°C to +70°C;
- Suitable for portable water, neutral liquids and sewage;
- WRAS approved.

Standards

- Flange: EN 1092-2;
- Coating: EN30677;
- Test: EN 12266-1.

Features

- Wide tolerance range;
- Corrosion resistant construction;
- Easy install even on out of round pipe;
- Restrain axial movement of pipe by special technology of "Connex Gripping Device";
- Angular deflection of +/-4°

Options

- Flange drilling with BS or ANSI standard;
- A2-70, A4-80;
- Various coating;
- Seal: NBR etc.

Assembly Chart

ITEM	DESCRIPTION	MATERIAL	STANDARD
1	END RING	EN GJS400-15	EN1563
2	GRIPPER	BRASS	EN1982
3	GRIPPER BOLT	CARBON STEEL	COMMERCIAL
4	RUBBER RING	EPDM	EN681-1
5	RING BOLT	CARBON STEEL	COMMERCIAL
6	BODY	EN GJS400-15	EN1563

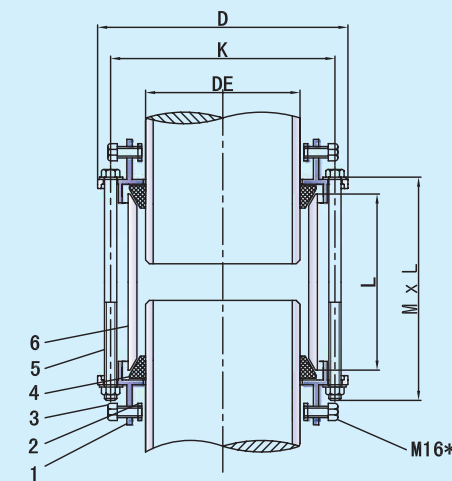

Specifications & Parameters Chart

DE	L	D	M*L	K	M16*N
355	170	510	M16×300×6	473	M16×6
400	180	556	M16×320×8	518	M16×8
500	180	658	M16×320×8	620	M16×8
630	200	790	M16×360×10	750	M16×10
710	200	870	M16×360×12	830	M16×12
800	220	965	M16×400×12	922	M16×12
900	220	1070	M16×400×14	1025	M16×14
1000	220	1172	M16×400×14	1128	M16×14
1200	240	1380	M16×430×16	1330	M16×16

Restraint Coupling-slim Type

Code:RPA5.EME.2

Briefs

- Connection for PE pipe;
- Working pressure PN10/16;
- Maximum temperature -10°C - +70°C;
- Suitable for portable water, neutral liquids and sewage;
- Wras approved;

Standards

- Design: EN12842
- Flange: EN1092-2;
- Coating: DIN 30677;
- Test: EN12266-1.

Features

- Light weight ductile iron pattern.
- Corrosion resistant construction
- Combined sealing ring give restraint and prevent blow off
- Angular deflection $\pm 3^\circ$

Options

- A2-70, A4-80;
- Various coating;
- Seal: NBR etc.

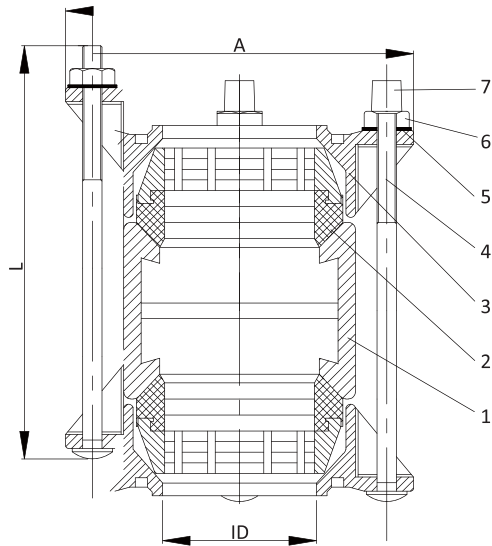

Assembly Chart

ITEM	DESCRIPTION	MATERIAL	STANDARD
1	CENTER SLEEVE	EN GJS 500-7	EN1563
2	SEALING RING	EPDM+BRASS	EN681 EN1982
3	END RING	EN GJS 500-7	EN1563
4	BOLTS	GD 4.8	COMMERCIAL
5	WASHER	STEEL	COMMERCIAL
6	NUTS	STEEL	COMMERCIAL
7	CAP	PLASTIC	COMMERCIAL

Specifications & Parameters Chart

DN(mm)	OD(mm)	ID(mm)	A(mm)	L(mm)	BOLTS QTY	WEIGHT(kg)
50	50	55	140	180	M12x2	3.61
50/60/65	63	67	165	180	M12x4	4.29
60/65	75	80	177	180	M12x4	4.39
80	90	95	193	180	M12x4	4.58
100	110	115	214	190	M12x4	6.44
125	125	130	240	190	M12x4	6.63
150	160	165	272	190	M12x4	8.39
200	200	205	314	210	M14x4	13.75
200	225	230	332	240	M14x4	14.72
250	250	255	365	240	M16x6	23.89
250	280	285	380	240	M16x6	24.89
300	315	320	431	270	M16x6	27.89

GIBAULT JOINT

Code: RPA4.EME.2

Briefs

- Connection for pipes in material PVC, AC etc;
- Working pressure PN10/16;
- Maximum temperature -10 C to +70 C ;
- Suitable for portable water, neutral liquids and sewage.

Standards

- Coating: EN30677;
- Test: EN 12266-1.

Features

- Corrosion resistant construction;
- Angular deflection of $\pm 3^\circ$.

Options

- GD8.8, Stainless steel, Dacromet bolt;
- Various coating;
- Seal: NBR etc.

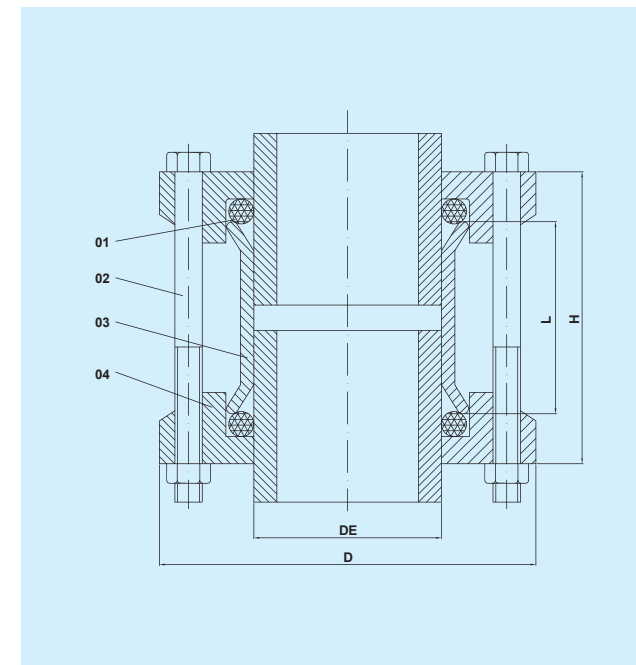

Assembly Chart

ITEM	DESCRIPTION	MATERIAL	STANDARD
1	O-RING	EPDM	EN 681-1
2	FASTENER	GD 4.8	COMMERCIAL
3	SLEEVE	EN GJS400-15	EN 1563
4	END RING	EN GJS400-15	EN 1563

Specifications & Parameters Chart

DE	L	H	D	BOLT	
				SIZE	QTY
63	125	150	137	M12X180	2
75	125	168	149	M12X180	2
90	125	154	164	M12X180	3
110	145	175	184	M12X210	3
125	145	189	199	M12X210	3
140	145	189	214	M12X220	4
160	185	215	234	M12X250	4
180	185	229	254	M12X250	4
200	185	229	274	M12X250	6
250	205	241	341	M12X280	6
315	205	241	406	M12X280	6

UNIVERSAL FLANGE ADAPTOR

Code: RPB1.EFE.2

Briefs

- Connection for pipes in material ductile iron, steel, PVC, AC etc;
- Working pressure PN10/16;
- Maximum temperature -10°C to +70°C;
- Suitable for portable water, neutral liquids and sewage;
- WRAS approved.

Standards

- Flange: EN 1092-2;
- Coating: EN30677;
- Test: EN 12266-1.

Features

- Wide tolerance range;
- Corrosion resistant construction;
- Total angular deflection of ± 4°.

Options

- Flange drilling with BS or ANSI standard;
- GD8.8, Stainless steel, Dacromet bolt;
- Various coating;
- Seal: NBR etc.

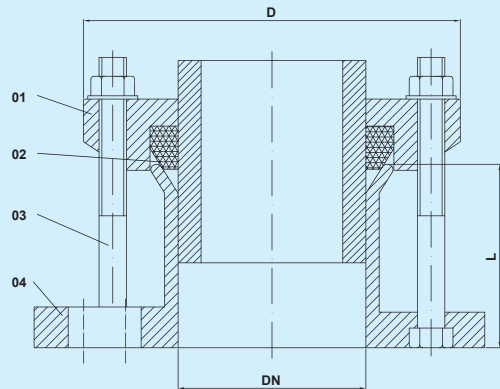

Assembly Chart

ITEM	DESCRIPTION	MATERIAL	STANDARD
1	END RING	EN GJS400-15	EN 1563
2	GASKET	EPDM	EN 681-1
3	FASTENER	GD 4.8	COMMERCIAL
4	BODY	EN GJS400-15	EN 1563

DN	RANGE	L	D	BOLT	
	mm	mm	mm	SIZE	QTY
350	374-391	110	510	M16X180	8
400	400-429	110	568	M16X180	8
400	418-435	110	580	M16X180	8
400	425-442	110	580	M16X180	8
450	476-493	115	640	M16X180	10
500	500-532	120	683	M16X180	10
500	527-544	120	690	M16X180	10
600	600-630	130	790	M16X180	10
600	630-647	130	820	M16X180	10

Specifications & Parameters Chart

DN	RANGE	L	D	BOLT	
	mm	mm	mm	SIZE	QTY
50	59-72	75	165	M12X130	2
65	72-85	75	185	M12X130	2
80	88-103	76	185	M12X130	4
100	109-128	78	218	M12X130	4
125	132-146	78	250	M12X130	4
150	159-182	80	272	M12X130	4
175	192-210	85	312	M12X130	4
200	218-235	85	335	M12X130	4
250	272-289	90	405	M12X130	6
300	315-332	90	460	M12X130	6

FLEXIBLE FLANGE ADAPTOR

Code: RPB2.EFE.2

Briefs

- Connection for pipes in material ductile iron, steel etc;
- Working pressure PN10/16/25;
- Maximum temperature -10°C to +70°C;
- Suitable for portable water, neutral liquids and sewage;
- WRAS approved.

Standards

- Flange: EN 1092-2;
- Coating: EN30677;
- Test: EN 12266-1.

Features

- Corrosion resistant construction;
- Total angular deflection as follows:
Under DN600 is ± 4°;
DN700-DN800 is ± 3°;
DN900-DN1200 is ± 2°.

Options

- Flange drilling with BS or ANSI standard ;
- GD8.8, Stainless steel, Dacromet bolt;
- Various coating;
- Seal: NBR etc.

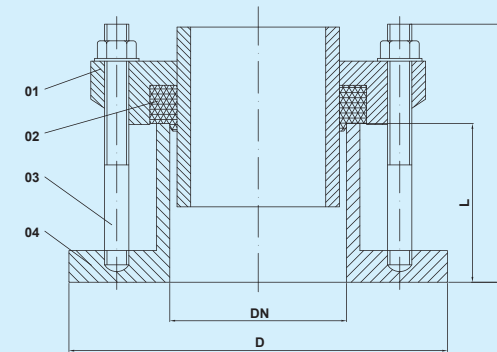

Assembly Chart

ITEM	DESCRIPTION	MATERIAL	STANDARD
1	END RING	EN GJS400-15	EN 1563
2	GASKET	EPDM	EN 681-1
3	FASTENER	GD 4.8	COMMERCIAL
4	BODY	EN GJS400-15	EN 1563

Specifications & Parameters Chart

DN	NOM. O.D.	O.D. TOL	L	H	D	BOLT	
	mm	mm	mm	mm	mm	SIZE	QTY
80	98	+2.1-2.6	73	108	200	M12x100	4
100	118	+2.1-3	76	115	220	M12x110	4
125	144	+2.3-3	76	115	250	M12x110	4
150	170	+2.3-3	76	115	285	M12x110	4
200	222	+2.4-3.5	76	115	340	M12x110	4
250	274	+2.5-3.5	90	127	400	M12x120	6
300	326	+2.6-3.5	90	127	455	M12x120	6
350	378	+2.7-3.5	108	152	505	M16x145	8
400	429	+2.8-4	108	152	565	M16x145	8

DN	NOM. O.D.	O.D. TOL	L	H	D	BOLT	
	mm	mm	mm	mm	mm	SIZE	QTY
450	480	+2.9-4	108	152	615	M16x145	10
500	532	+3-4	114	160	670	M16x150	10
600	635	+3.2-4	114	160	780	M16x150	10
700	738	+3.4-4.5	114	160	895	M16x150	12
800	842	+1-4.5	114	160	1015	M16x150	12
900	945	+1-5	114	160	1115	M16x150	14
1000	1048	+1-5	114	160	1230	M16x150	14
1100	1152	+1-6	127	178	1340	M16x165	16
1200	1255	+1-6	127	178	1435	M16x165	16
1400	1462	+1-7	127	230	1675	M39x220	36

RESTRAINT FLANGE ADAPTOR

Code: RPB3.EFE.2

Briefs

- Connection for HDPE pipe;
- Working pressure PN10/16;
- Maximum temperature -10°C to +70°C;
- Suitable for portable water, neutral liquids and sewage;
- WRAS approved.

Standards

- Flange: EN 1092-2;
- Coating: EN30677;
- Test: EN 12266-1.

Features

- Corrosion resistant construction.

Options

- Flange drilling with BS or ANSI standard;
- A2-70, A4-80;
- Various coating;
- Seal: NBR etc.

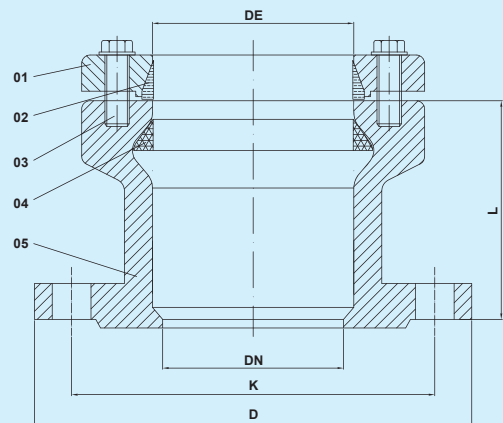

Assembly Chart

ITEM	DESCRIPTION	MATERIAL	STANDARD
1	END RING	EN GJS400-15	EN 1563
2	GRIP	BRASS	EN1982
3	FASTENER	STAINLESS STEEL	ASTM A276
4	GASKET	EPDM	EN 681-1
5	BODY	EN GJS400-15	EN 1563

Specifications & Parameters Chart

DN	DE	K	D	L	BOLT
	mm	mm	mm	mm	M×No.
50	63	125	165	74	M10×2
65	75	145	185	74	M10×4
80	90	160	200	76	M10×4
100	110	180	220	76	M10×4
125	125	210	250	80	M10×4
125	140	210	250	80	M10×4
150	160	240	285	90	M10×4
150	180	240	285	96	M10×4
200	225	295	340	110	M10×4
250	250	350	400	130	M10×6
250	280	350	400	125	M10×6
300	315	410	455	150	M10×6

Restraint flange adaptor

Code: RPB3.EFE.2

Briefs

- Connection for PE pipe;
- Working pressure PN10/16;
- Maximum temperature -10°C - +70°C;
- Suitable for portable water, neutral liquids and sewage;
- Wras approved;

Standards

- Design: EN12842
- Coating: DIN 30677;
- Test: EN12266-1

Features

- Lightweight ductile iron pattern.
- Corrosion resistant construction
- Simple grip to restraint and prevent blow off
- Angular deflection ±3°

Options

- A2-70, A4-80;
- Various coating;
- Seal: NBR etc.

Assembly Chart

ITEM	DESCRIPTION	MATERIAL	STANDARD
1	FLANGE ADAPTER	EN GJS 400-15	EN1563
2	GASKET	EPDM	EN681-1
3	THREADED TIE ROD	GD 4.8	COMMERCIAL
4	GRIP	GD4.8+ZINC PLATED CAST IRON	COMMERCIAL
5	END RING	EPDM	EN 1563

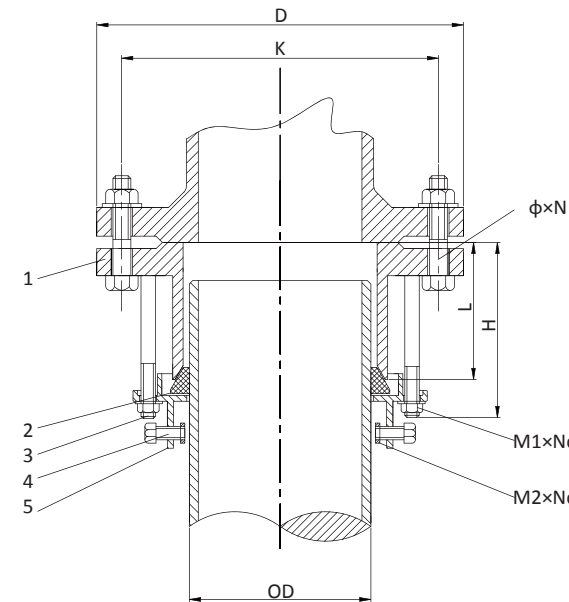
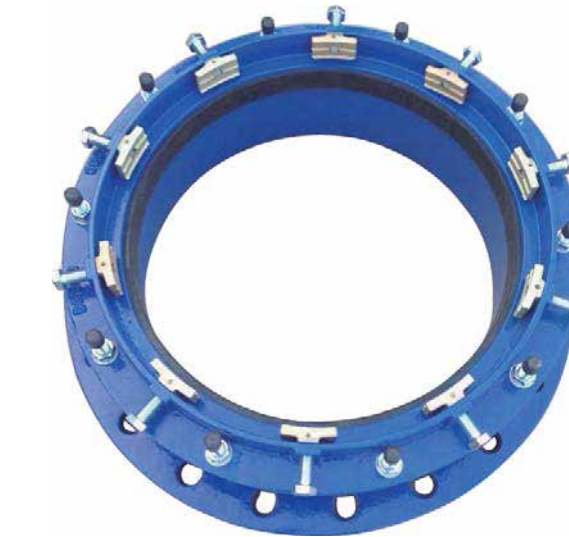

Specifications & Parameters Chart

DN	OD	D	K	L	H	φ×N (mm)	M1×No.(mm)	M2×No.(mm)	NOTE
300	355	455	410	140	200	28×12	M16×6	M16×6	stepped
350	355	520	470	100	170	28×16	M16×8	M16×8	straight
400	425	580	525	150	220	31×16	M16×8	M16×8	stepped
400	400	580	525	100	170	31×16	M16×8	M16×8	straight
450	455	640	585	100	170	31×20	M16×10	M16×10	straight
500	500	715	650	110	190	34×20	M16×10	M16×10	straight
600	630	840	770	110	190	37×20	M16×10	M16×10	straight
700	710	910	840	120	200	37×24	M16×12	M16×12	straight
800	800	1025	950	120	210	40×24	M16×12	M16×12	straight
900	900	1125	1050	140	240	40×28	M16×14	M16×14	straight
1000	1000	1485	1170	140	240	43×28	M16×14	M16×14	straight
1200	1200	1685	1390	150	260	49×32	M16×16	M16×16	straight

Restraint Flange Adaptor-slim Type Code: RPB5.EFE.2

Briefs

- Connection for PE pipe;
- Working pressure PN10/16;
- Maximum temperature -10°C - +70°C;
- Suitable for portable water, neutral liquids and sewage;
- Wras approved;

Standards

- Design: EN12842
- Flange: EN1092-2;
- Coating: DIN 30677;
- Test: EN12266-1

Features

- Light weight ductile iron pattern.
- Corrosion resistant construction
- Combined sealing ring give restraint and prevent blow off
- Angular deflection ±3°

Options

- Flange drilling with BS or ANSI standard;
- A2-70, A4-80 bolt;
- Various coating;
- Seal: NBR etc.

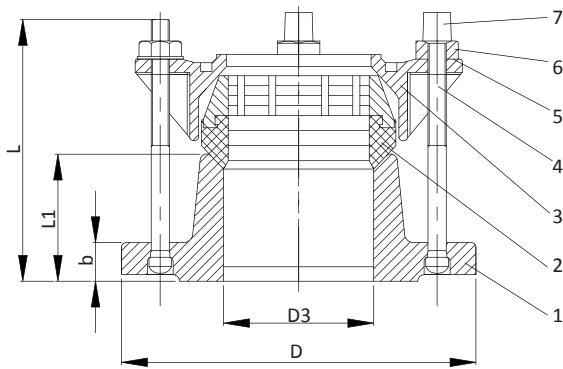

Assembly Chart

ITEM	DESCRIPTION	MATERIAL	STANDARD
1	BODY	EN GJS500-7	EN1563
2	SEALING RING	EPDM+BRASS	EN681 EN1982
3	END RING	EN GJS500-7	EN1563
4	BOLTS	GD 4.8	COMMERICAL
5	WASHER	STEEL	COMMERICAL
6	NUTS	STEEL	COMMERICAL
7	CAP	PLASTIC	COMMERICAL

Specifications & Parameters Chart

DN(mm)	OD(mm)	D3(mm)	D(mm)	b(mm)	L1	L	L	DIN DN PN10/16	WEIGHT(kg)
50	50	50	165	19	63	115	M12×2	·	3.61
50/60/65	63	78	180	19	63	110	M12×4	·	4.29
60/65	75	92	180	19	63	110	M12×4	·	4.39
80	90	105	180	19	63	110	M12×4	·	4.58
100	110	126	200	19	63	110	M12×4	·	6.44
125	125	135	220	19	63	120	M12×4	·	6.63
150	160	177	285	19	63	120	M12×4	·	8.39
200	200	217	340	19	63	130	M14×4	·	13.75
200	225	214	340	20	88	140	M14×4	·	14.72
250	250	268	400	22	88	140	M16×6	·	23.89
250	280	275	400	22	88	150	M16×6	·	24.89
300	315	334	455	24	88	150	M16×6	·	27.89

PE/PVC QUICK ADAPTOR Code: RPB4.EFE.2

Briefs

- Connection for pipes in material PE, PVC etc;
- Working pressure PN10/16;
- Maximum temperature -10°C to +70°C;
- Suitable for portable water, neutral liquids and sewage;
- WRAS approved.

Standards

- Flange: EN 1092-2;
- Coating: EN30677;
- Test: EN 12266-1.

Features

- Corrosion resistant construction.

Options

- Flange drilling with BS or ANSI standard;
- Various coating;
- Seal: NBR etc;
- For PVC pipe without brass grip.

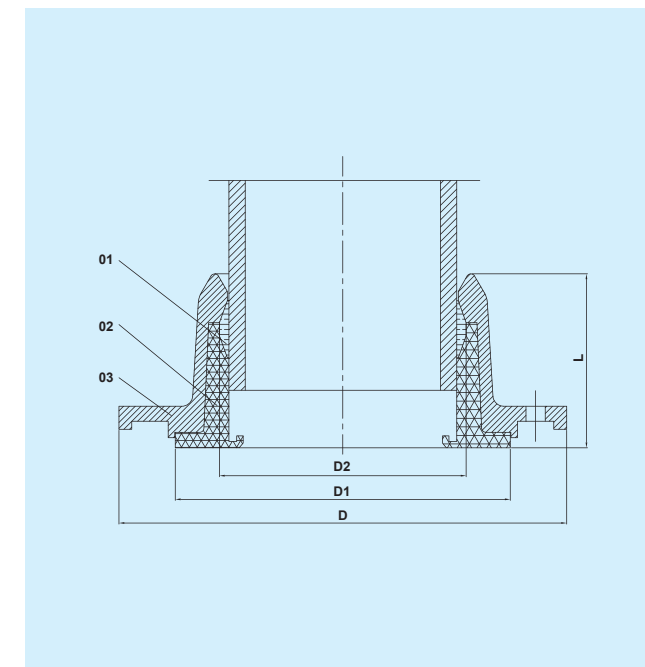

Assembly Chart

ITEM	DESCRIPTION	MATERIAL	STANDARD
1	GRIP	BRASS	EN1982
2	GASKET	EPDM	EN 681-1
3	BODY	EN GJS400-15	EN 1563

Specifications & Parameters Chart

DN	NOM. O.D. mm	D1 mm	D2 mm	L mm	D mm
50	66	93	74	46	165
65	66	93	74	46	185
65	78	103	86	50	185
80	93	125	101	52	200
100	113	143	122	58	220
100	128	163	137	60	220
125	128	163	137	60	250
125	143	177	152	65	250

DN	NOM. O.D. mm	D1 mm	D2 mm	L mm	D mm
150	164	203	172	74	285
150	184	224	194	76	285
200	204	259	214	76	340
200	229	274	239	80	340
250	254	310	264	90	400
250	284	326	294	92	400
300	319	360	329	100	455
400	415	456	414	122	580

DISMANTLING JOINT Code: RPC1.EFE.2



Briefs

- provides easy installation and disassembly of flanged equipment;
- Working pressure PN10/16/25/40;
- Maximum temperature -10 °C to +70 °C ;
- Suitable for portable water, neutral liquids and sewage.

Standards

- Flange: EN 1092-2;
- Coating: EN30677;
- Test: EN 12266-1.

Features

- Corrosion resistant construction;
- Studs are located on every flange hole;
- Tie rods are required from the upstream to downstream sides of the pipe equipment installation.

Options

- Flange drilling with BS or ANSI standard;
- GD8.8, Stainless steel, Dacromet bolt;
- Various coating;
- Seal: NBR etc.

Assembly Chart

ITEM	DESCRIPTION	MATERIAL	STANDARD
1	STUD	GD 4.8	COMMERCIAL
2	SHORT PIECE	EN GJS400-15	EN 1563
3	RETAINING FLANGE	EN GJS400-15	EN 1563
4	GASKET	EPDM	EN 681-1
5	LONG PIECE	EN GJS400-15	EN 1563
6	NUT	GD 4.8	COMMERCIAL

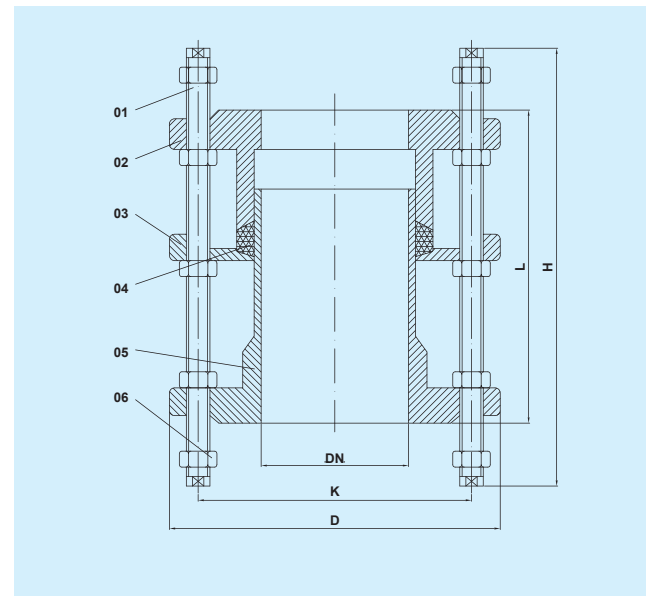

Specifications & Parameters Chart

DN	PN10					PN16					PN25				
	L	D	K	H	STUD	L	D	K	H	STUD	L	D	K	H	STUD
40	180	150	110	330	M16X4	180	150	110	330	M16X4	190	150	110	340	M16X4
50	180	165	125	330	M16X4	180	165	125	330	M16X4	200	165	125	350	M16X4
65	180	185	145	330	M16X4	180	185	145	330	M16X4	200	185	145	350	M16X8
80	200	200	160	350	M16X8	200	200	160	350	M16X8	210	200	160	360	M16X8
100	200	220	180	350	M16X8	200	220	180	350	M16X8	220	235	190	370	M20X8
125	200	250	210	350	M16X8	200	250	210	350	M16X8	220	270	220	380	M24X8
150	200	285	240	350	M20X8	200	285	240	350	M20X8	230	300	240	390	M24X8
200	220	340	295	380	M20X8	220	340	295	380	M20X12	230	360	310	400	M24X12
250	220	400	350	380	M20X12	230	400	355	400	M24X12	250	425	370	430	M27X12
300	220	455	400	390	M20X12	250	455	410	420	M24X12	250	485	430	440	M27X16
350	230	505	460	400	M20X16	260	520	470	440	M24X16	270	555	490	470	M30X16
400	230	565	515	410	M24X16	270	580	525	460	M27X16	280	620	550	490	M33X16
450	250	615	565	430	M24X20	270	640	585	470	M27X20	280	670	600	490	M33X20
500	260	670	620	450	M24X20	280	715	650	490	M30X20	300	730	660	520	M33X20
600	260	780	725	460	M27X20	300	840	770	520	M33X20	320	845	770	560	M36X20
700	260	895	840	460	M27X24	300	910	840	520	M33X24	340	960	875	590	M39X24
800	290	1010	950	500	M30X24	320	1025	950	550	M36X24	360	1085	990	630	M45X24
900	290	1115	1050	500	M30X28	320	1125	1050	560	M36X28	380	1185	1090	660	M45X28
1000	290	1230	1160	510	M33X28	340	1255	1170	600	M39X28	400	1320	1210	690	M52X28
1200	320	1455	1380	570	M36X32	360	1485	1390	650	M45X32	450	1530	1420	780	M52X32

*Size 1200+ are available on application

Dismantling Joint(ANSI150) Code: RPC2.AFE.2



Briefs

- Provides easy installation and disassembly of ANSI flanged equipment;
- Working pressure CL150;
- Maximum temperature -10°C - +70°C;
- Suitable for portable water, neutral liquids and sewage;
- Wras approved;

Standards

- Design: AWWA C110
- Flange: ANSI B16.5
- Coating: DIN 30677;
- Test: EN12266-1

Features

- Capable of absorbing expansion and contraction of pipeline
- Corrosion resistant construction
- Accommodate angular deflection for pipeline movement or ground settlement.

Options

- A2-70, A4-80 or dacromet coating bolt;
- Various coating;
- Seal: NBR etc.

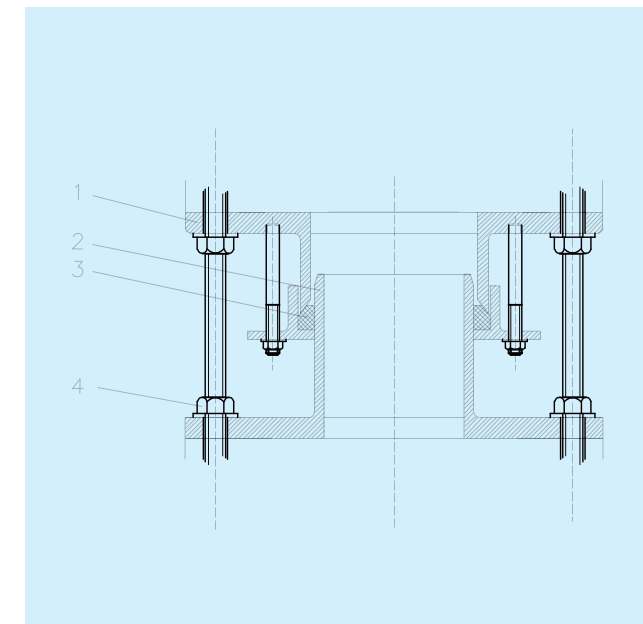

Assembly Chart

ITEM	DESCRIPTION	MATERIAL	STANDARD
1	FLANGE ADAPTER	EN GJS 400-15	EN1563
2	FLANGED SPIGOT	EN GJS 400-15	EN1563
3	GASKET	EPDM	EN681-1
4	THREADED TIE ROD	GD 4.8	COMMERCIAL

Specifications & Parameters Chart

DN(Nominal)	Flange OD inch mm	Nominal Length		Min Length		Max Length		Weight kg
		LN(mm)	LN(inch)	LN(mm)	LN(inch)	LN(mm)	LN(inch)	
4"	100	229	8	178	7	229	9	16
6"	150	279	8.38	187	7.38	238	9.38	25
8"	200	343	8.38	187	7.38	238	9.38	33
10"	250	406	10.5	241	9.5	292	11.5	49
12"	300	483	10.5	241	9.5	292	11.5	61

TAPPER SADDLE

Code: RPD1.ETE.2

Briefs

- Connection for pipes in material PE, PVC etc;
- Working pressure PN10/16;
- Maximum temperature -10°C to +70°C;
- Suitable for portable water, neutral liquids and sewage.

Standards

- Coating: EN30677;
- Test: EN 12266-1.

Features

- Corrosion resistant construction.

Options

- GD8.8, A2-70, A4-80, Dacromet bolt;
- Various coating;
- Seal: NBR etc;
- M thread type: G3/4", G1", G1"1/4, G1"1/2, G2".

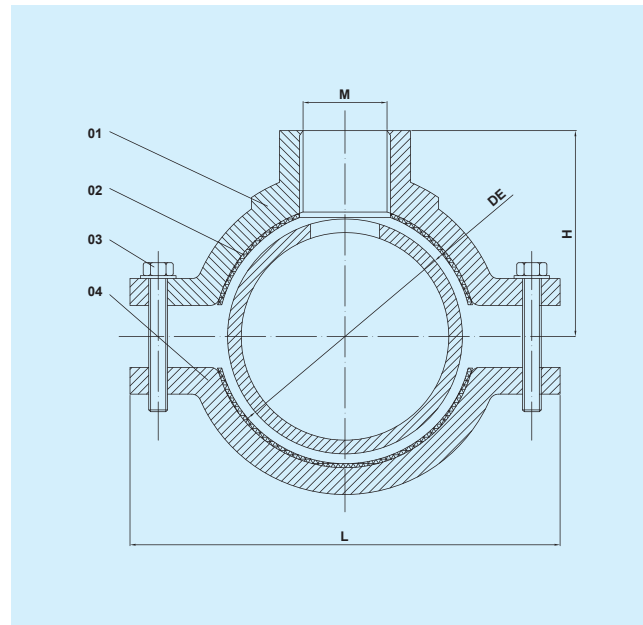

Assembly Chart

ITEM	DESCRIPTION	MATERIAL	STANDARD
1	UPPER BODY	EN GJS400-15	EN 1563
2	GASKET	EPDM	EN 681-1
3	FASTENER	STAINLESS STEEL	ASTM A276
4	LOWER BODY	EN GJS400-15	EN 1563

DE	H mm	L mm	BOLT	
			SIZE	QTY
160	118	234	M12X55	4
180	135	266	M12X60	6
200	135	285	M12X60	6
225	142	305	M12X70	6
250	164	330	M12X70	6
280	172	361	M12X70	6
315	195	393	M12X80	6

Specifications & Parameters Chart

DE	H mm	L mm	BOLT	
			SIZE	QTY
50	63	125	M10X30	4
63	66	125	M10X35	4
75	71	136	M10X40	4
90	78	152	M10X40	4
110	87	174	M10X45	4
125	100	193	M12X50	4
140	100	215	M12X50	4

Adjustable Bell joint Repair Clamp

Code: RPE4.EME.2

Briefs

- Connection or repair of leaking sockets and spigot joints on cast iron/ductile iron pipes;
- Also can be used for the repairing of leakages on joints of pipes of other material (A/C, fiber glass, steel, plastic);
- Normal pressure PN10;
- Maximum temperature -10°C to +70°C;
- Suitable for portable water, neutral liquids and sewage;

Standards

- Design: EN545
- Flange: EN1092-2
- Coating: DIN30677;
- Test: EN 12266-1;

Features

- Flexible contact;
- Safe and reliable;
- Instant and convenient application.

Options

- GD8.8, Stainless steel, Dacromet bolt;
- Various coating;
- Seal: NBR etc.

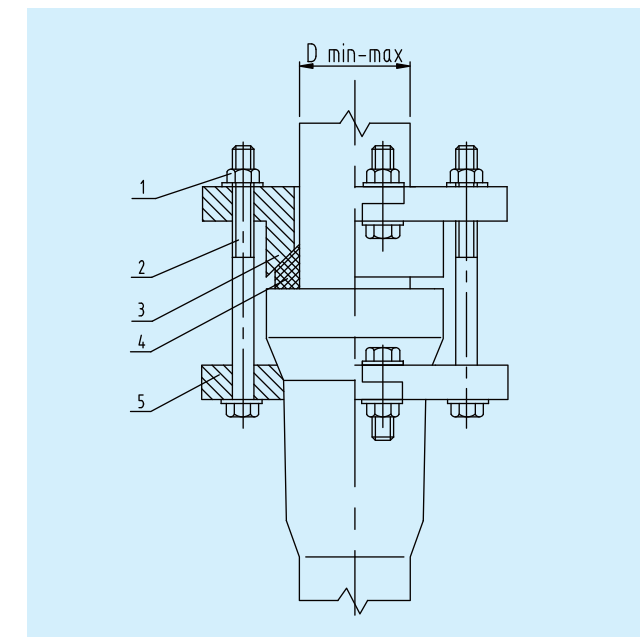
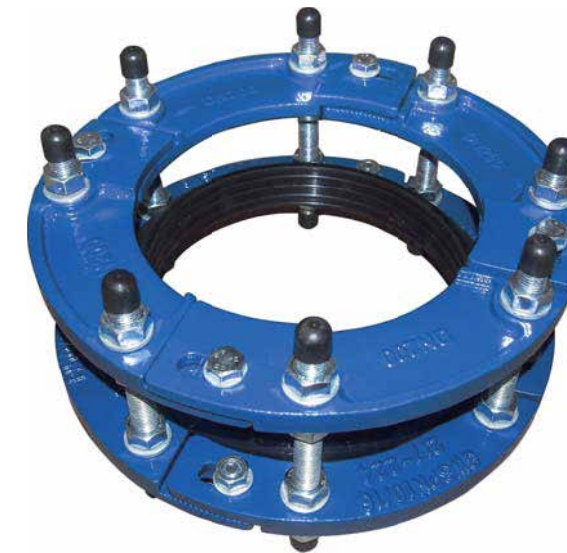

Specifications & Parameters Chart

DN	Range D min - max (mm)
50	62-68
65	75-84
80	94-100
100	114-120
150	166-173
200	217-224
250	270-276
300	321-328
350	373-380
400	424-431
500	527-534
600	630-638

Assembly Chart

ITEM	DESCRIPTION	MATERIAL	STANDARD
1	NUT	GD 4.8	COMMERCIAL
2	BOLTS	GD 4.8	COMMERCIAL
3	SPIGOT RING	EN GJS400-15	EN1563
4	GASKET	EPDM	EN681
5	BELL RING	EN GJS400-15	EN1563